

SERIES 225

INCH DIAL INDICATOR



ACCUD

- ◆ Meet ASME B89.1.10M-2001
- ◆ Supplied with limit hands and bezel clamp
- ◆ Lug back

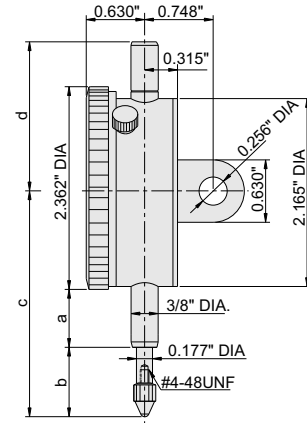

Graduation .001"

225-025-11

Code	Range	Dial reading	Range/rev	Accuracy		a	b	c	d
				First 2.5 rew	Overall				
225-006-11	0.25"	0-100	0.1"	±0.001"	±0.001"	0.787"	0.984"	2.953"	1.811"
225-012-11	0.5"	0-100	0.1"	±0.001"	±0.002"	0.787"	0.984"	2.953"	1.811"
225-025-11	1"	0-100	0.1"	±0.001"	±0.002"	0.787"	1.378"	3.346"	1.811"
225-050-11	2"	0-100	0.1"	±0.001"	±0.004"	1.969"	2.323"	5.472"	4.370"

Graduation .0005"

Code	Range	Dial reading	Range/rev	Accuracy		a	b	c	d
				First 2.5 rew	Overall				
225-006-05	0.25"	0-50	0.05"	±0.0005"	±0.0015"	0.787"	0.984"	2.953"	1.811"
225-012-05	0.5"	0-50	0.05"	±0.0005"	±0.0015"	0.787"	0.984"	2.953"	1.811"
225-025-05	1"	0-50	0.05"	±0.0005"	±0.002"	0.787"	1.378"	3.346"	1.811"
225-050-05	2"	0-50	0.05"	±0.0005"	±0.002"	1.969"	2.323"	5.472"	4.370"

With manufacturer inspection certificate

