

Ball Point

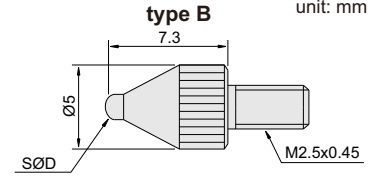

270-001-03

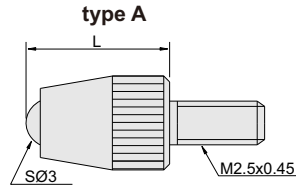

unit: mm

type A

Code	Material	L
270-001-01	carbide	7.3
270-001-02	ceramic	7.3
270-001-03	carbide	8.3
270-001-91	ruby	8.5
270-001-04	carbide	12.1
270-001-05	carbide	14
270-001-06	carbide	15
270-001-07	ceramic	15
270-001-08	carbide	17
270-001-09	carbide	19.3
270-001-10	carbide	20
270-001-11	ceramic	20
270-001-12	carbide	22
270-001-13	carbide	25
270-001-14	ceramic	25
270-001-15	carbide	30
270-001-16	ceramic	30

type B

Code	Material	SØD	L
270-001-21	steel	1	7.3
270-001-210	carbide	1	6
270-001-22	carbide	1.5	7.3
270-001-23	carbide	1.8	7.3
270-001-220	carbide	2	7
270-001-24	carbide	2.5	7.3
270-001-230	carbide	3	8
270-001-235	carbide	3.5	8.5
270-001-25	carbide	4	9
270-001-245	carbide	4.5	9.5
270-001-250	carbide	5	10
270-001-255	carbide	5.5	10
270-001-260	carbide	6	10.5
270-001-270	carbide	7	11.5

\* NEW

\* NEW

\* NEW

\* NEW

\* NEW

\* NEW

\* NEW

\* NEW

\* NEW

Package



Shell Type Point

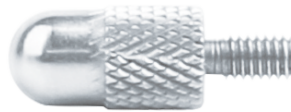

270-002-02

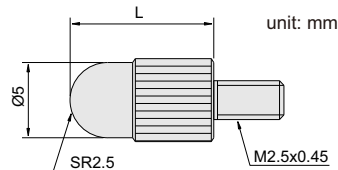

unit: mm

Package



Code	Material	L
270-002-01	steel	5
270-002-02	steel	10
270-002-03	steel	15
270-002-04	steel	20
270-002-05	steel	25
270-002-06	steel	30

Spherical Point

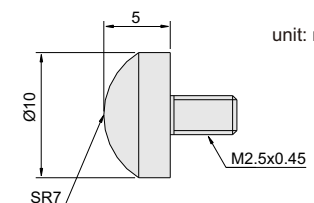

unit: mm

Code	Material
270-003-01	steel

Package



**Conical Point**



**270-004-02**

**270-004-10**

unit: mm

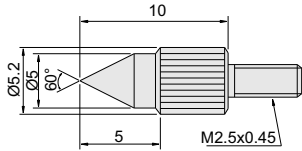

**270-004-01**

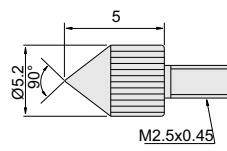

**270-004-02**

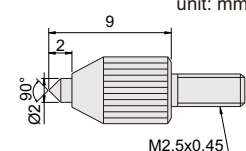

**270-004-03**

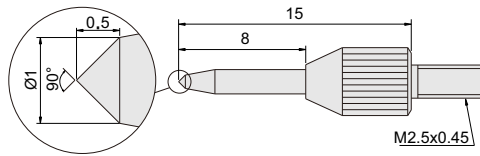

**270-004-04**

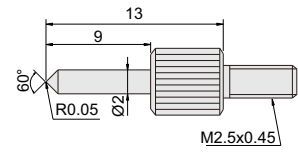

**270-004-10**

Code	Material
270-004-01	steel
270-004-02	steel
270-004-03	steel
270-004-04	steel

Code	Material
270-004-10	steel

\* **NEW**

**type A**

Code	Material	L
270-005-01	steel	8
270-005-02	steel	10

**Flat Point**

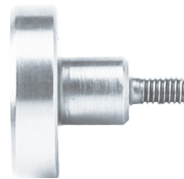

**270-005-12**



**270-010-16**

**type B**

Code	Material	ØD
270-005-11	steel	10
270-005-12	steel	15
270-005-13	steel	20
270-005-14	steel	25
270-005-15	steel	30

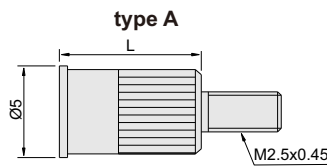

unit: mm

**type D**

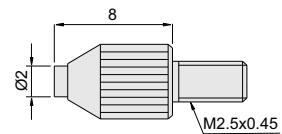

**type C**

Code	Material	ØD
270-010-16	ceramic	10

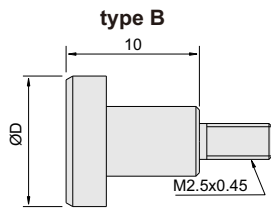

**type E**

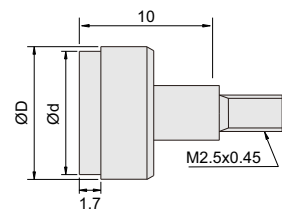

**type D**

Code	Material
270-005-21	carbide

**type C**

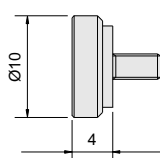

**type E**

Code	Material	Ød	ØD
270-010-01	steel	6.5	7
270-010-02	steel	9.5	10.5



**SERIES 270**

**CONTACT POINTS**

Code	Material	ØD	L
270-006-01	steel	0.45	3
270-006-02	steel	0.45	5
270-006-03	carbide	1	3
270-006-04	carbide	1	5
270-006-05	carbide	1	8
270-006-06	carbide	1	10
270-006-07	carbide	1	20
<b>* NEW</b> 270-006-071	carbide	1	30
270-006-08	carbide	1	40
<b>* NEW</b> 270-006-081	carbide	1	50
270-006-09	carbide	1.5	5
270-006-10	carbide	1.5	10
270-006-11	carbide	1.5	13
270-006-12	carbide	1.5	20
<b>* NEW</b> 270-006-121	carbide	1.5	30
270-006-13	carbide	1.5	40
<b>* NEW</b> 270-006-131	carbide	1.5	50
270-006-14	carbide	2	8
<b>* NEW</b> 270-006-141	carbide	2	10
270-006-15	carbide	2	18
<b>* NEW</b> 270-006-151	carbide	2	20
270-006-16	carbide	2	28
<b>* NEW</b> 270-006-161	carbide	2	30
270-006-17	carbide	2	40
<b>* NEW</b> 270-006-171	carbide	2	50

**Needle Point**



270-006-16

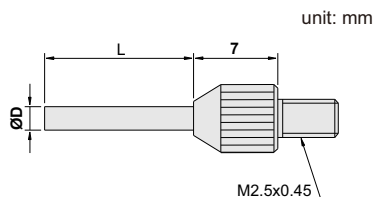

**\* NEW**

Code	Material	ØD	L
270-606-11	ceramic	1	10
270-606-12	ceramic	1	20
270-606-151	ceramic	1.5	10
270-606-152	ceramic	1.5	20
270-606-153	ceramic	1.5	30
270-606-154	ceramic	1.5	40
270-606-155	ceramic	1.5	50
270-606-21	ceramic	2	10
270-606-22	ceramic	2	20
270-606-23	ceramic	2	30
270-606-24	ceramic	2	40
270-606-25	ceramic	2	50

Package



**Needle Point**



270-006-53

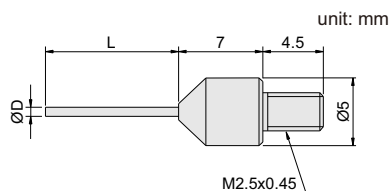

**\* NEW**

Code	Material	ØD	L
270-006-51	carbide	0.5	5
270-006-52	carbide	0.5	10
270-006-53	carbide	0.5	15
270-006-54	carbide	0.5	20
270-006-55	carbide	0.5	30
270-006-56	carbide	0.5	40
270-006-57	carbide	0.5	50
270-006-61	carbide	0.6	10
270-006-62	carbide	0.6	15
270-006-63	carbide	0.6	20
270-006-71	carbide	0.7	10
270-006-72	carbide	0.7	15

**\* NEW**

Code	Material	ØD	L
270-006-73	carbide	0.7	20
270-006-81	carbide	0.8	5
270-006-82	carbide	0.8	10
270-006-83	carbide	0.8	15
270-006-84	carbide	0.8	20
270-006-85	carbide	0.8	30
270-006-86	carbide	0.8	40
270-006-87	carbide	0.8	50
270-006-91	carbide	0.9	10
270-006-92	carbide	0.9	15
270-006-93	carbide	0.9	20

Package





**SERIES 270**

**CONTACT POINTS**

**Needle Point**



270-006-22

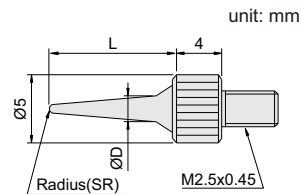

	Code	Material	L	ØD	SR
* NEW	270-006-217	steel	7	2	0.15
* NEW	270-006-211	steel	13	2	0.15
* NEW	270-006-212	steel	22	2	0.15
* NEW	270-006-213	steel	30	2	0.15
* NEW	270-006-214	steel	40	2	0.15
	270-006-22	steel	13	2	0.2
* NEW	270-006-225	steel	50	2	0.2
* NEW	270-006-313	steel	7	2	0.3
* NEW	270-006-317	steel	13	2	0.3
* NEW	270-006-322	steel	22	2	0.3
* NEW	270-006-330	steel	30	2	0.3
* NEW	270-006-340	steel	40	2	0.3
	270-006-21	steel	11	2	0.4
	270-006-23	steel	21	2	0.4
	270-006-24	steel	31	2	0.4
* NEW	270-006-450	steel	50	2	0.4

**\* NEW**

Code	Material	L	ØD	SR
270-006-2013	carbide	13	2	0.2
270-006-2022	carbide	22	2	0.2
270-006-2030	carbide	30	2	0.2
270-006-2040	carbide	40	2	0.2
270-006-2050	carbide	50	2	0.2
270-006-3513	carbide	13	2	0.35
270-006-3522	carbide	22	2	0.35
270-006-3530	carbide	30	2	0.35
270-006-3540	carbide	40	2	0.35
270-006-3550	carbide	50	2	0.35

Package



**Knife Edge Point**

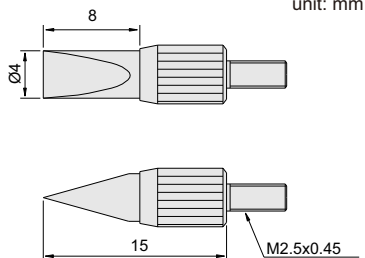

Code	Material
270-007-01	steel

Package



**Blade Point**



270-008-03

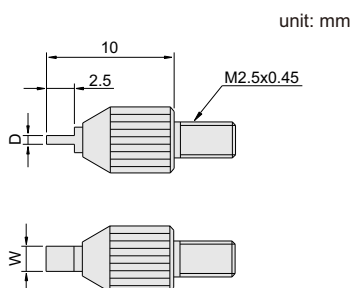

Code	Material	D	W
270-008-01	steel	0.4	2
270-008-02	steel	0.6	2
270-008-03	steel	1	4

Package





**Ball Point**

Code	Material	SØD
270-011-01	carbide	1
270-011-02	carbide	1.5
270-011-03	carbide	2
270-011-04	carbide	2.5
270-011-05	carbide	3
270-011-06	carbide	3.5
270-011-07	carbide	4
270-011-08	carbide	4.5
270-011-09	carbide	5
270-011-10	carbide	5.5
270-011-11	carbide	6
270-011-12	carbide	6.5
270-011-14	carbide	7
270-011-16	carbide	8
270-011-18	carbide	9
270-011-20	carbide	10
270-011-24	carbide	12



270-011-08

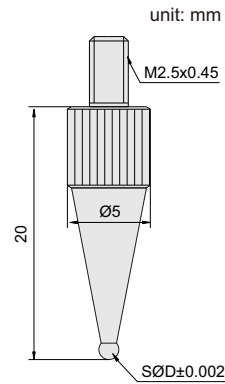

Package



**\* NEW**

Code	Material	SØD	L
270-012-11	carbide	1	10
270-012-12	carbide	1	20
270-012-13	carbide	1	30
270-012-14	carbide	1	40
270-012-15	carbide	1	50
270-012-151	carbide	1.5	10
270-012-152	carbide	1.5	20
270-012-153	carbide	1.5	30
270-012-154	carbide	1.5	40
270-012-155	carbide	1.5	50
270-012-21	carbide	2	10
270-012-22	carbide	2	20
270-012-23	carbide	2	30
270-012-24	carbide	2	40
270-012-25	carbide	2	50
270-012-251	carbide	2.5	10
270-012-252	carbide	2.5	20
270-012-253	carbide	2.5	30
270-012-254	carbide	2.5	40
270-012-255	carbide	2.5	50
270-012-31	carbide	3	10
270-012-32	carbide	3	20
270-012-33	carbide	3	30
270-012-34	carbide	3	40
270-012-35	carbide	3	50

**Ball Point**



270-012-022

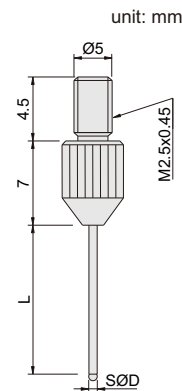

**\* NEW**

Code	Material	SØD	L
270-012-011	ruby	1	10
270-012-012	ruby	1	20
270-012-013	ruby	1	30
270-012-014	ruby	1	40
270-012-015	ruby	1	50
270-012-021	ruby	2	10
270-012-022	ruby	2	20
270-012-023	ruby	2	30
270-012-024	ruby	2	40
270-012-025	ruby	2	50

Package



## SERIES 270

## CONTACT POINTS

### Flat Point

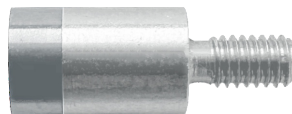

270-020-05

Package

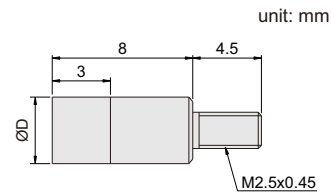

Code	Material of measuring face	ØD
270-020-04	carbide	4
270-020-05	carbide	5
270-020-06	carbide	6
270-020-08	carbide	8
270-020-10	carbide	10

