

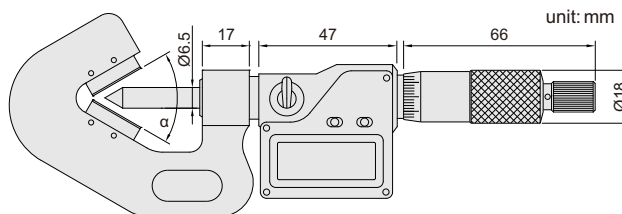

334-020-01

- ◆ Measure the diameter of parts or cutting tools with odd grooves such as taps, reamers and end mills
- ◆ Resolution: 0.001mm/0.00005"
- ◆ Button: on/off, set, mm/inch, ABS/INC, data output
- ◆ Automatic power off, Ratchet stop
- ◆ Data output
- ◆ Carbide measuring faces



3 flutes

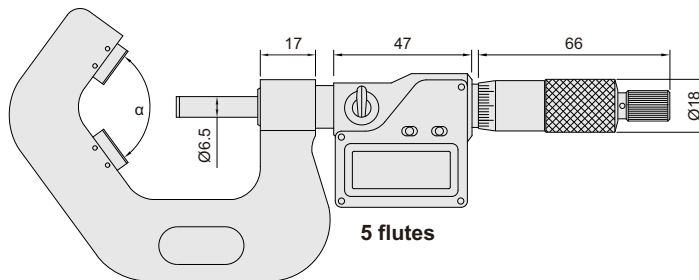

5 flutes

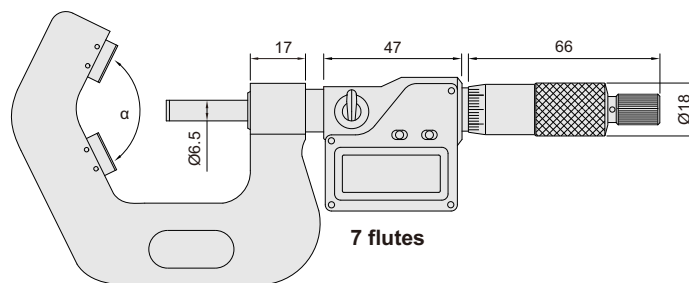

7 flutes

Setting standards (included)

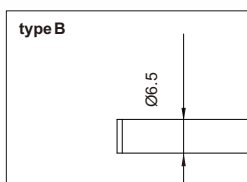
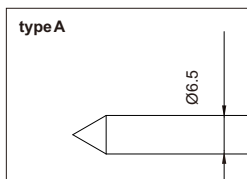

Code	Range	Accuracy	Flutes	α	Type	Setting standards (included)
334-015-01	1-15mm/0.04-0.6"	$\pm 4\mu\text{m}$	3	60°	A	5mm
334-020-01	5-20mm/0.2-0.8"	$\pm 4\mu\text{m}$	3	60°	B	5mm
334-035-01	20-35mm/0.8-1.4"	$\pm 5\mu\text{m}$	3	60°	B	20mm
334-050-01	35-50mm/1.4-2.0"	$\pm 5\mu\text{m}$	3	60°	B	35mm
334-025-55	5-25mm/0.2-1.0"	$\pm 4\mu\text{m}$	5	108°	B	5mm
334-045-55	25-45mm/1.0-1.8"	$\pm 5\mu\text{m}$	5	108°	B	25mm
334-065-55	45-65mm/1.8-2.6"	$\pm 6\mu\text{m}$	5	108°	B	50mm
334-085-55	65-85mm/2.6-3.4"	$\pm 6\mu\text{m}$	5	108°	B	65mm
334-105-55	85-105mm/3.3-4.2"	$\pm 6\mu\text{m}$	5	108°	B	85mm
* NEW 334-025-77	5-25mm/0.2-1.0"	$\pm 4\mu\text{m}$	7	$128^\circ 34' 17''$	B	5mm
* NEW 334-045-77	25-45mm/1.0-1.8"	$\pm 4\mu\text{m}$	7	$128^\circ 34' 17''$	B	25mm
* NEW 334-065-77	45-65mm/1.8-2.6"	$\pm 5\mu\text{m}$	7	$128^\circ 34' 17''$	B	50mm
* NEW 334-085-77	65-85mm/2.6-3.4"	$\pm 5\mu\text{m}$	7	$128^\circ 34' 17''$	B	65mm