

- ◆ Micrometer head accuracy: $\pm 3\mu\text{m}$
- ◆ Rod accuracy: $\pm(2+L/75)\mu\text{m}$,
L is the measuring range in mm
- ◆ Supplied with rods
- ◆ Ratchet stop

| Code | Range | Base (HxW) | Rod |
|------------|---------|------------|-------|
| 392-001-01 | 0-25mm | 101.5x17mm | 1pc |
| 392-002-01 | 0-50mm | 101.5x17mm | 2pcs |
| 392-003-01 | 0-75mm | 101.5x17mm | 3pcs |
| 392-004-01 | 0-100mm | 101.5x17mm | 4pcs |
| 392-006-01 | 0-150mm | 101.5x17mm | 6pcs |
| 392-008-01 | 0-200mm | 101.5x17mm | 8pcs |
| 392-012-01 | 0-300mm | 101.5x17mm | 12pcs |
| 392-001-02 | 0-25mm | 63x17mm | 1pc |
| 392-002-02 | 0-50mm | 63x17mm | 2pcs |
| 392-003-02 | 0-75mm | 63x17mm | 3pcs |
| 392-004-02 | 0-100mm | 63x17mm | 4pcs |
| 392-006-02 | 0-150mm | 63x17mm | 6pcs |
| 392-008-02 | 0-200mm | 63x17mm | 8pcs |
| 392-012-02 | 0-300mm | 63x17mm | 12pcs |

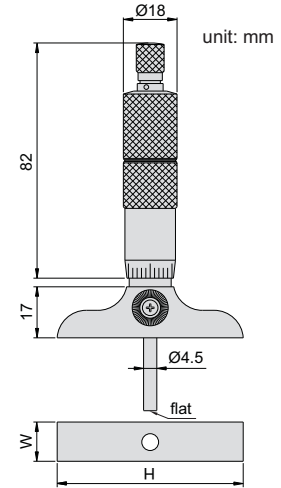

392-001-01



Rod (included)

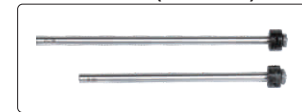

Install rod



use

