

822

## DIGITAL PROTRACTOR



### ◆ Button function:

SET: preset the reading and change the measuring direction

MODE: choose range 90°, 180°, 360°

ZERO/ON/OFF: set zero and power on/off

### ◆ Data output

◆ With a 150mm blade and a 90° square

◆ Made of stainless steel



Set zero

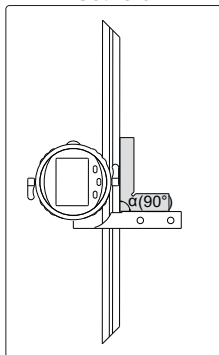

150mm blade(included)

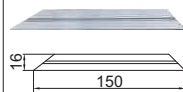

90°square(included)

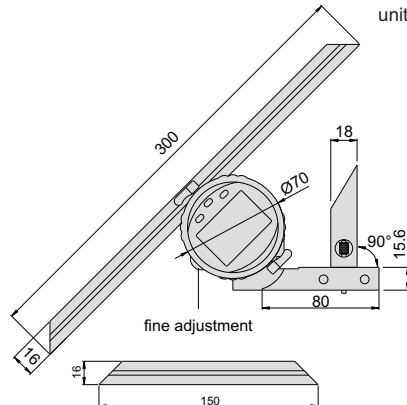

unit: mm

Application

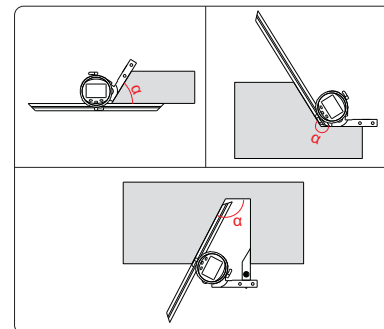

Code	Range	Resolution	Accuracy
822-360-01	0 - 360°	10"/0.005°	±5'