

AP
Milling Inserts

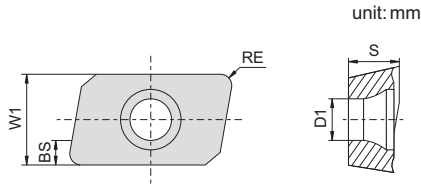

Application: ● Fit well ○ Applicable

Workpiece material	P	Steel	
	M	Stainless steel	
	K	Cast iron	
	N	Non-ferrous metal	●
	S	Heat-resistant alloy; Titanium alloy	
	H	High hardness steel	

Shape	Specification	Insert grade	W1	S	BS	D1	RE	Coated	Cutting conditions	Excellent
MA 	APKT1135PDFR-MA	CA10	6.35	3.5	1.2	2.8	0.8	×	☺	★
	APKT1604PDFR-MA		9.525	4.76	1.4	4.6	0.8	×	☺	★
MA3 	APKT1604PDFR-MA3		9.525	4.76	1.4	4.6	0.8	×	☺	★
G2 	APGT1135PDFR-G2		6.35	3.5	1.2	2.8	0.8	×	☺	★
	APGT1604PDFR-G2		9.525	4.76	1.4	4.6	0.8	×	☺	★

- Note: ● Stable(Continuous/Finish)
 ☺ Average(Medium/Finish/Rough)
 ✘ Tough(Interrupted/Rough)
 ★ Excellent ☆ Good